

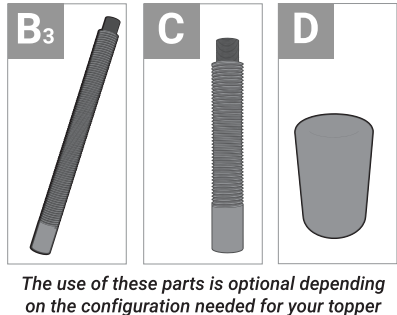

www.VillageLighting.com

ADJUSTABLE TREE TOPPER SUPPORT

MODEL #: V-20910 V4 | Patents Pending

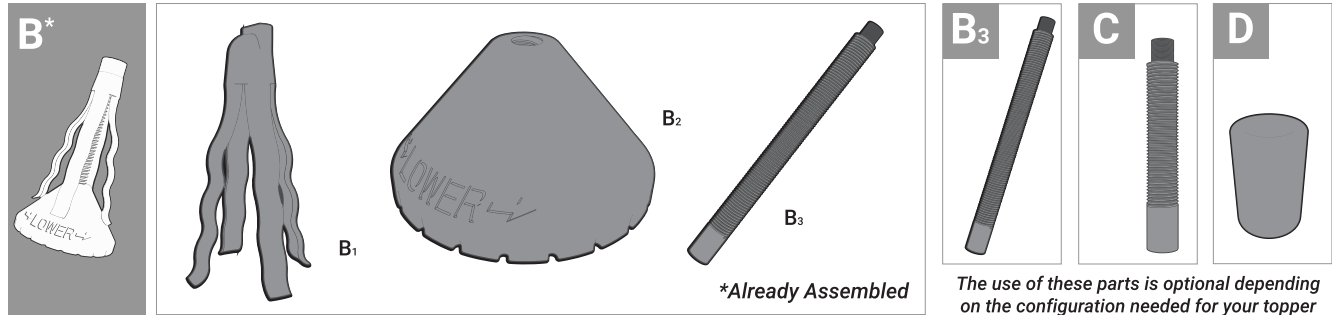
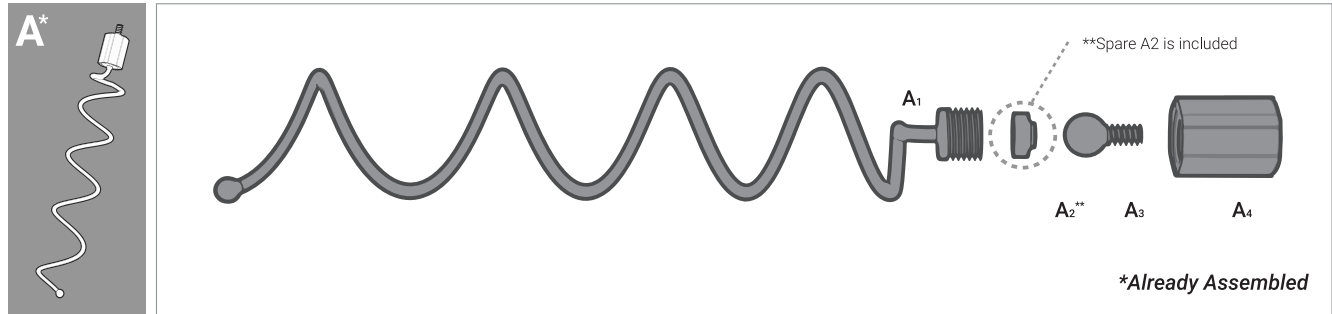

! IS YOUR TOPPER CONE LOOSE?



1

TIGHTEN THE CONE & ROD CLOCKWISE

2

TIGHTEN THE BALL JOINT HOUSING



3

STILL LOOSE? REMOVE THE CONE AND HOUSING. CHECK IF PART A2 IS INCLUDED.

IF MISSING, USE SPARE A2 TO REPLACE

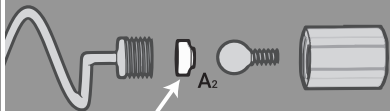

ATTACH THE ADJUSTABLE CONE*



**Assembly may vary depending on your topper. See next page for configurations.*

LEVEL THE CONE

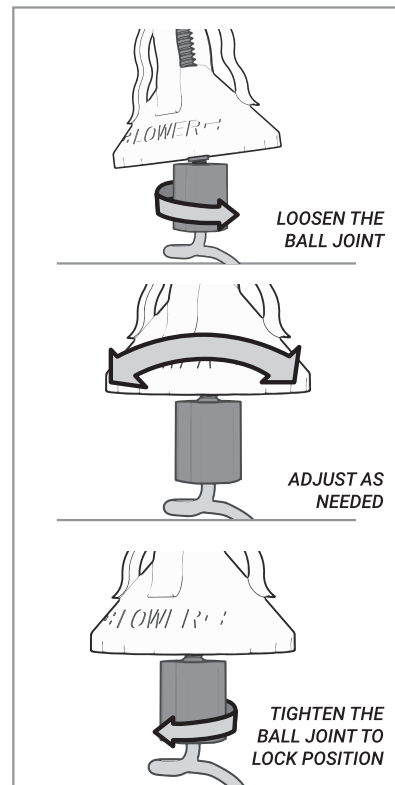

THREAD DIRECTIONS

LOWER CONE IS REVERSE THREADED

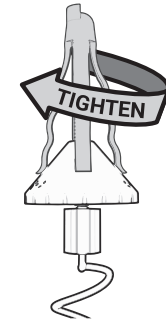
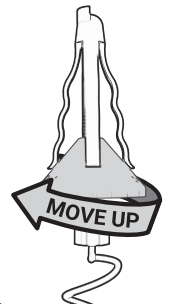

UPPER CONE IS STANDARD THREADED

CENTER ROD CONNECTION TO BALL JOINT IS STANDARD THREADED

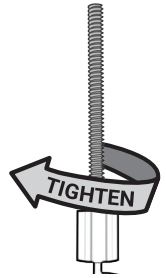

SEE NEXT PAGE FOR CUSTOM SETUPS



ROTATE CONE TO ADJUST SIZE

CONFIGURATIONS *CUSTOMIZE ASSEMBLY TO MATCH YOUR TOPPER STYLE*

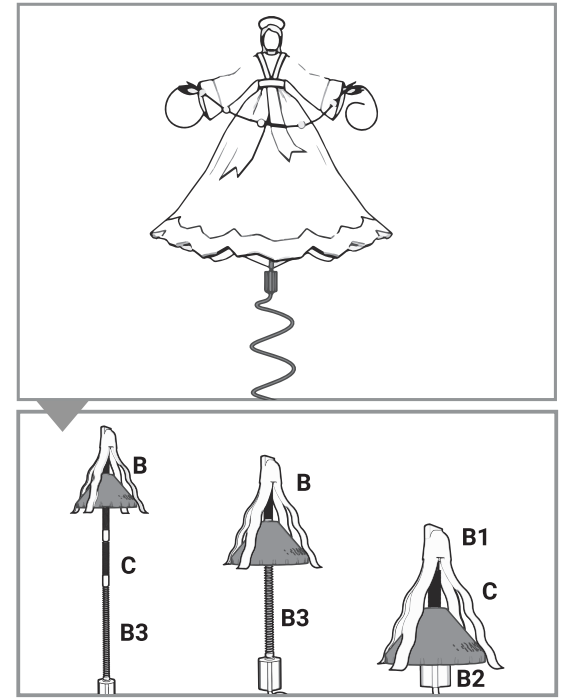
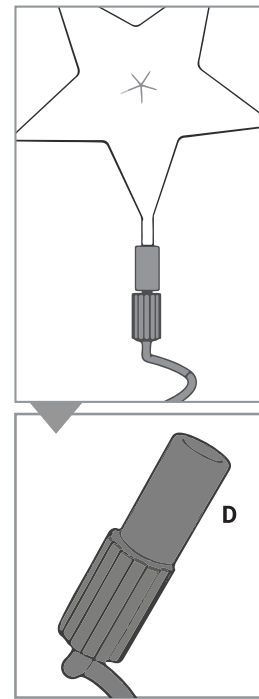
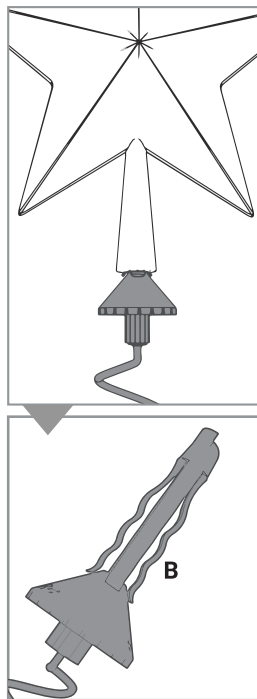
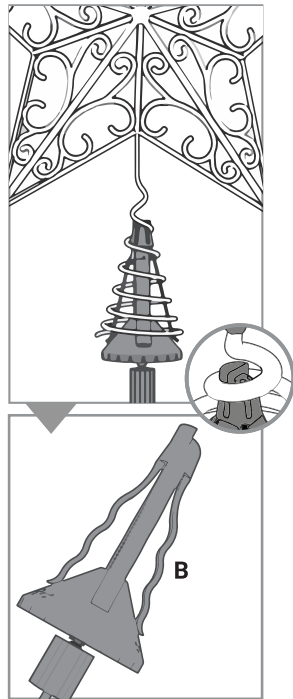
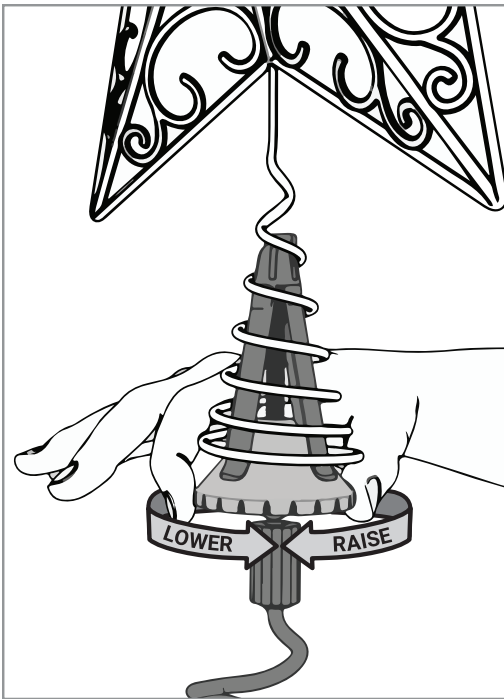

CONFIGURATIONS *(CONTINUED)*

SWITCH TO SHORT ROD (PART C)

