



EZ Load & Level™ Tree Stand for 6-9 Foot trees

TK-10828-RS (V2024) | Patent Pending

EZ™
**LOAD &
LEVEL**

Parts

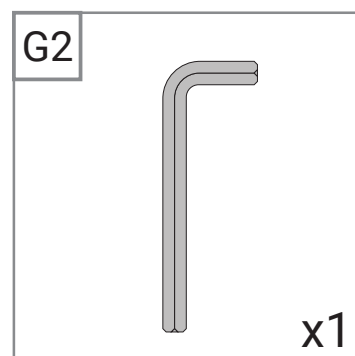
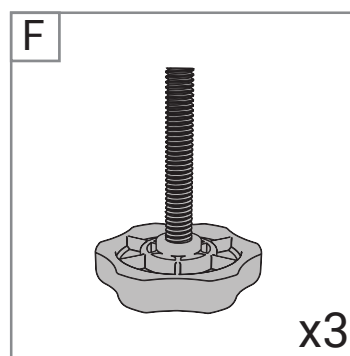
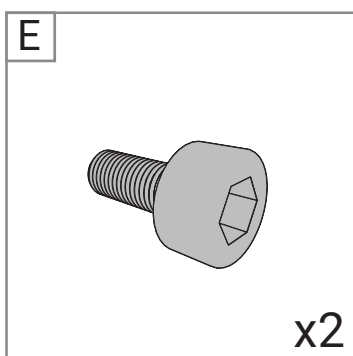
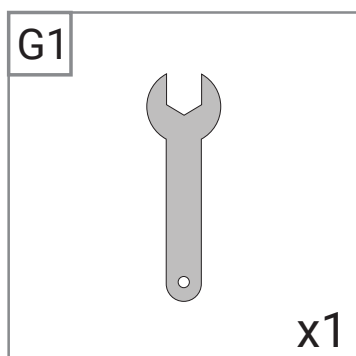
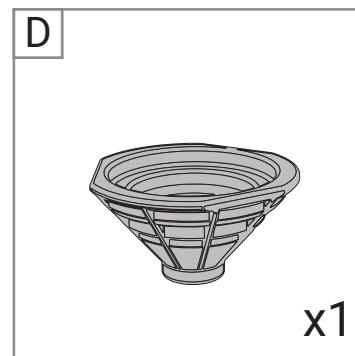
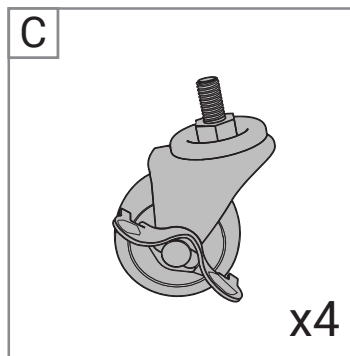
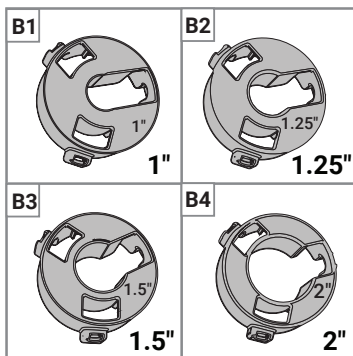
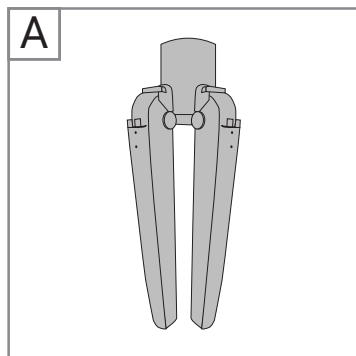

Assembly Steps

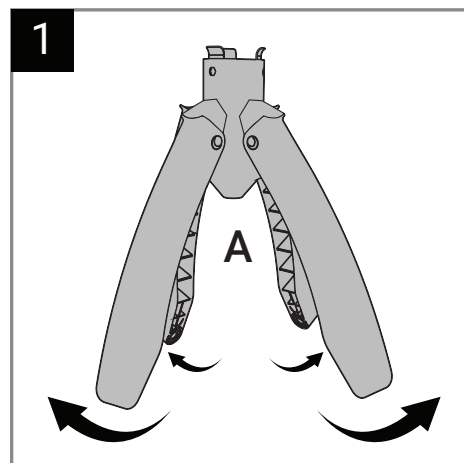

Unfold the legs.

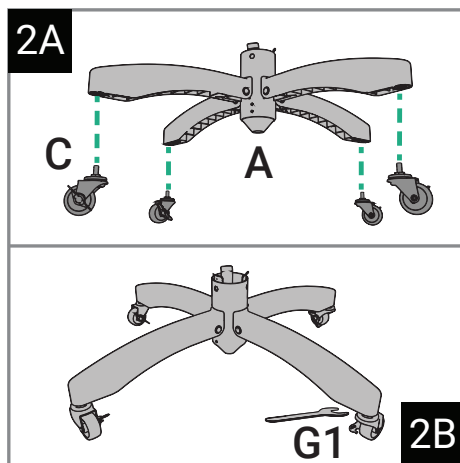

Install wheels. Secure the wheels firmly with the wrench.

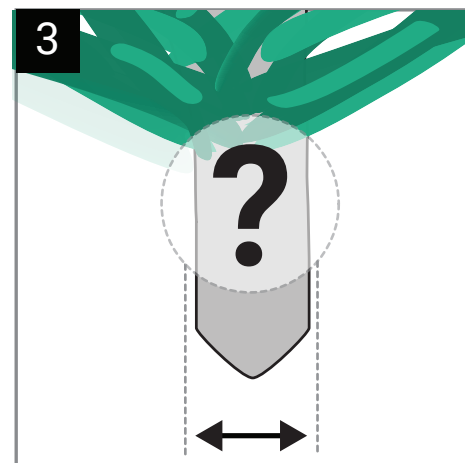

Measure your tree pole.



Follow the step below that matches your tree pole size.

<1"



MY TREE POLE IS LESS THAN 1 INCH IN DIAMETER

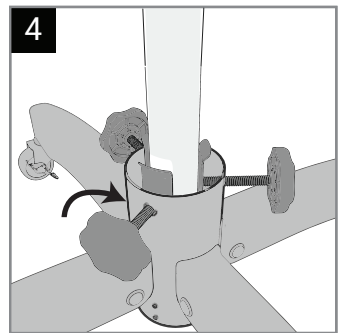
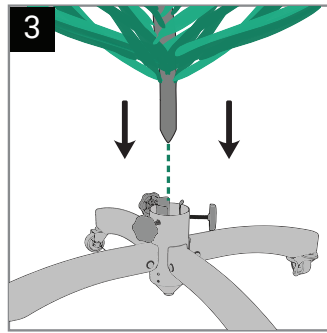
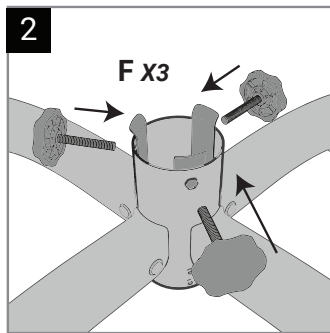
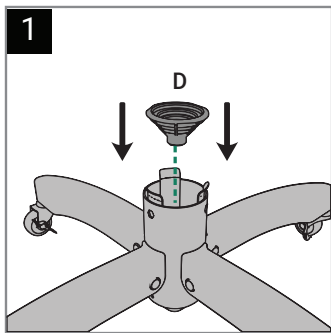

1"



1.25"



1.5"



2"



1, 1.25, 1.5 AND 2 INCH TREE POLES

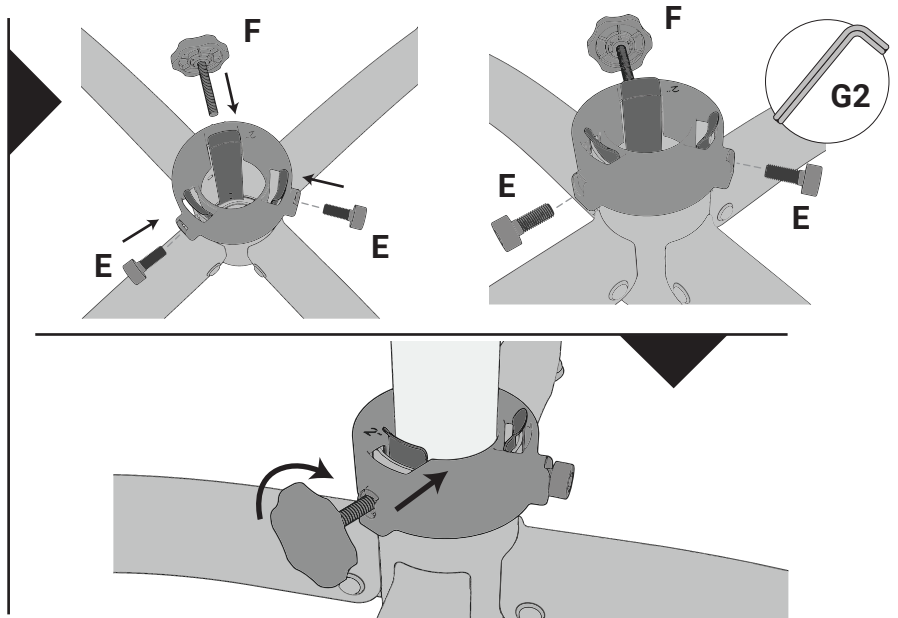
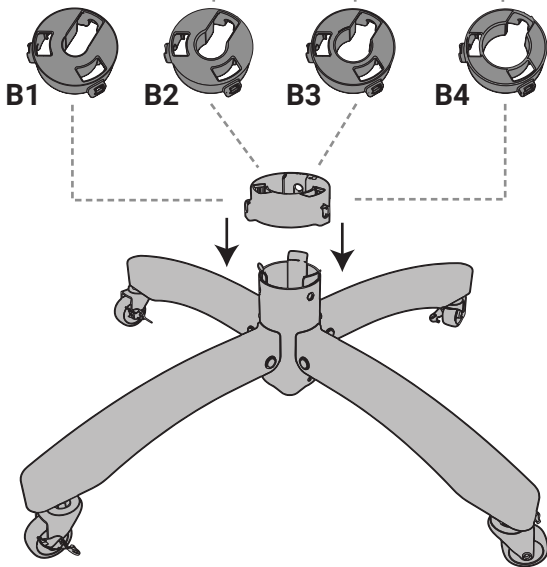

*



ALL OTHER TREE POLE SIZES

