



**TREEKEEPER™**

WWW.TREEKEEPERBAGS.COM

For assistance with assembly or installation, parts and customer service:  
www.TreeKeeperBags.com/Help | Support@VillageLighting.com

# DECORATED UPRIGHT TREE BAG

MODEL #: TK-10104  
PATENT NO. US 7,694,494 B2

## PARTS :

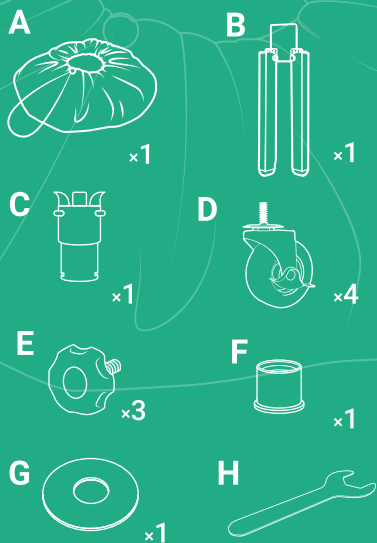

IMPORTANT, RETAIN FOR FUTURE REFERENCE:  
READ CAREFULLY

Intended for indoor use

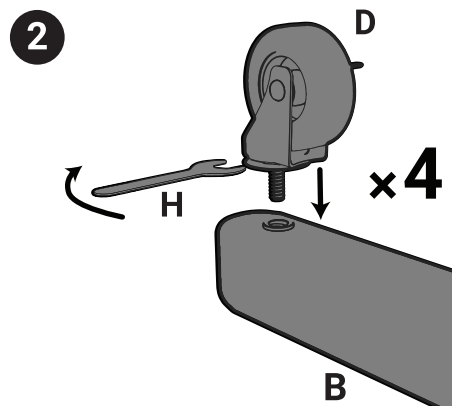
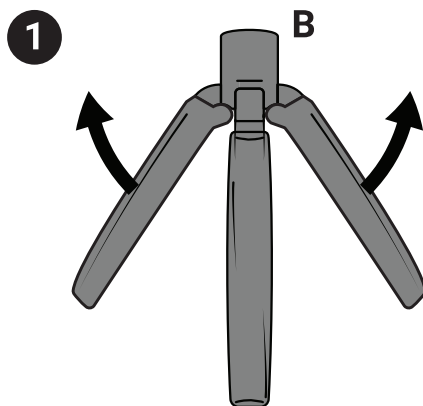

## 3 Installing onto your tree stand

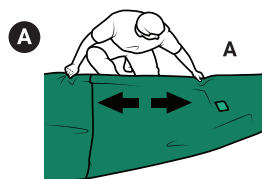

To install on the stand, bag must have an opening through the middle from top to bottom. To do this, first lay flat on the ground.



Reach your arm through the bag from top to bottom and extend your hand out of the bottom hole. Line the hole up with the tree stand collar and install.

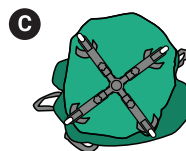

Flip the stand over and fasten the buckles and straps.

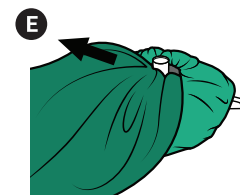
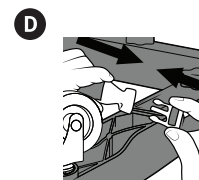

Once again, lay the bag out flat to proceed to the next step.

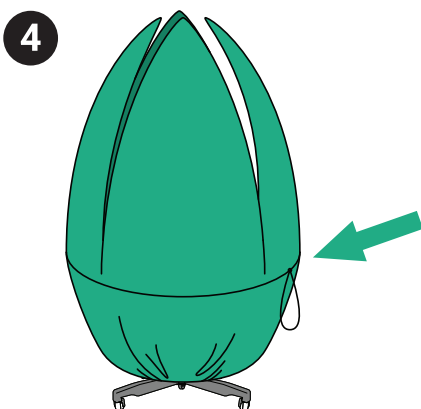

Locate the drawstring near the lower portion of the bag.



Tuck the fabric above the drawstring into the lower portion of the bag.

*Do not cover the tree stand collar.*

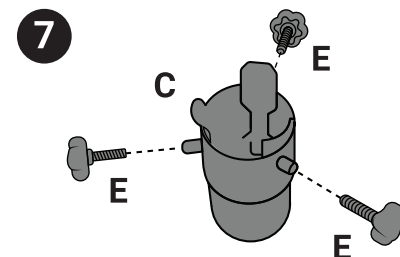
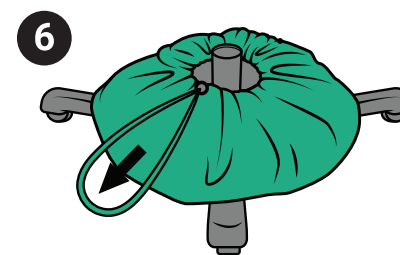



**TREEKEEPER™**  
WWW.TREEKEEPERBAGS.COM

For assistance with assembly or installation, parts and customer service:  
www.TreeKeeperBags.com/Help | Support@VillageLighting.com

# DECORATED UPRIGHT TREE BAG

MODEL #: TK-10104  
PATENT NO. US 7,694,494 B2

## CAUTION



DO NOT lean the bag on it's side and pull all the weight of the tree on one or two legs. Doing so could cause damage your tree stand, tree, or yourself. ALWAYS use caution when leaning the tree over. DO NOT put too much pressure on the stand while tipped as this could result in damaging the trunk of the tree. Use CAUTION when lifting the tree as it may be heavy. Use EXTREME CAUTION when moving the tree up or down stairs. Whenever possible, USE TWO OR THREE PEOPLE TO STORE YOUR TREE.

IMPORTANT, RETAIN FOR FUTURE REFERENCE:  
READ CAREFULLY

Intended for indoor use

8

**IMPORTANT: ASSEMBLY VARIES BY TREE POLE SHAPE AND SIZE. PLEASE FOLLOW INSTRUCTIONS BELOW**

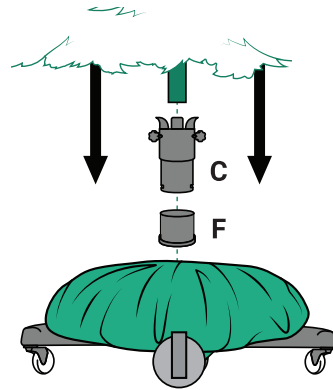

ALL SIZES FLAT BOTTOM, OR LESS THAN 1.25" DIAMETER POLE

INSERT PART "F" INTO THE CENTER OF THE STAND UNDER PART C

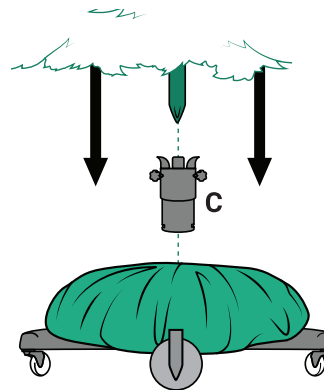

1.5" - 2.12" DIAMETER POINTED POLE

NO ADDITIONAL PARTS NEEDED

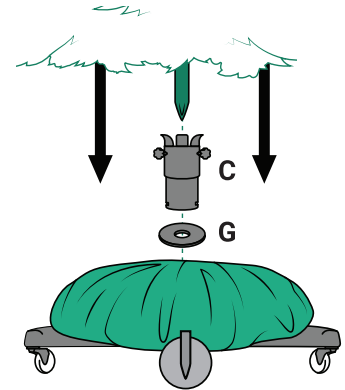

1.25" - 1.5" DIAMETER POINTED POLE

INSERT PART "G" INTO THE CENTER OF THE STAND UNDER PART C

## Storing your tree After Christmas

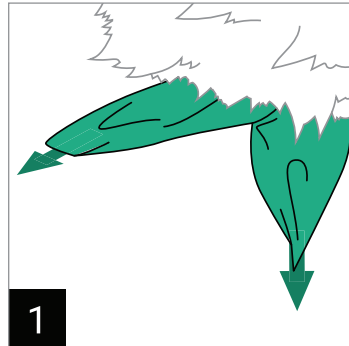

1 Loosen the drawstring and expand four sections flat on the ground around your tree.



2 Locate the section with the ring. Hook the other sections to this ring and place atop your tree.



3 Starting at the bottom, zip up each section until your bag is fully closed.

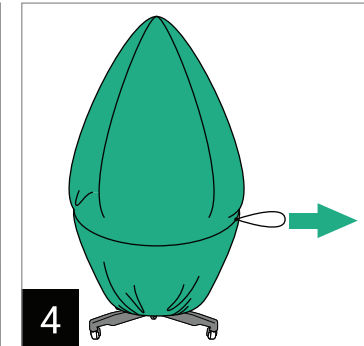

4 Locate the drawstring and pull gently to further tighten and compress your tree.

## Taking the Bag Down

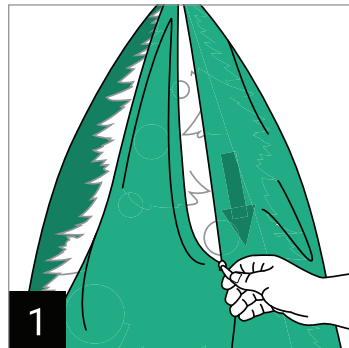

1 Release all drawstrings and unzip each section of the bag.



2 Grab the top of your tree bag and unhook each section.

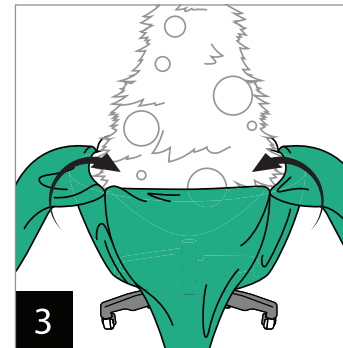

3 Tuck the four sections of the bag inward toward the tree base.

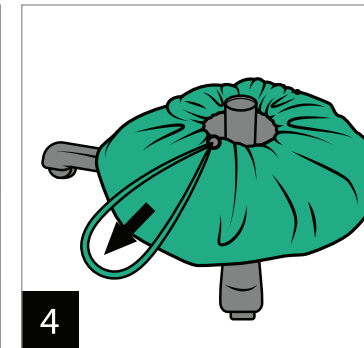

4 Pull the drawstring to enclose the bag under your tree.